



August 31, 2016

RE: Notice of Public Hearing, Hawks Glenn PPL, LAND-2015-01452
Public Hearing before the Hearing Examiner

Sarah:

Attached is the public notice to be posted no later than MONDAY, SEPTEMBER 5, 2016, at the following location:

1 public notice to be posted on the project site.

The Office of the Hearing Examiner will post a copy at City Hall and the Redmond Library. Please find included a Certification of Public Notice for you to sign and include in your Technical Committee Report.

Please let me know if you have any questions.

Sincerely,

CITY OF REDMOND
MICHELLE M. HART, MMC, *M* -
CITY CLERK

Ceryl Xanthos
CHERYL XANTHOS, CMC,
DEPUTY CITY CLERK

CITY OF REDMOND NOTICE OF PUBLIC HEARING

PROJECT INFORMATION

PROJECT NAME: HAWKS GLEN PPL APPLICATION TYPE: LAND DIVISION SUBDIVISION

FILE NUMBER: LAND-2015-01425

PROJECT DESCRIPTION: SUBDIVIDE A 9.77 ACRES SITE INTO 27 RESIDENTIAL LOTS

PROJECT LOCATION: 17656 NE 116TH STREET, REDMOND, WA, 98052

SITE ADDRESS, IF APPLICABLE: N/A SIZE OF SUBJECT AREA IN ACRES: 9.77 SQ.FT. 420,000 SQFT

APPLICANT: BLUELINE CONSULTING PROCESS TYPE: TYPE III

SEPA THRESHOLD DETERMINATION: DNS

REQUIRED PERMITS, NOT A PART OF THIS APPLICATION: BUILDING PERMITS

REQUIRED STUDIES: GEOLOGIC HAZARD REPORT, STORMWATER REPORT, STREAM RECONNAISSANCE REPORT, TRAFFIC STUDY, TREE HEALTH ASSESSMENT, WETLAND REPORT, WILDLIFE REPORT

EXISTING ENVIRONMENTAL DOCUMENTS, RELEVANT TO THIS APPLICATION: SEPA CHECKLIST

REGULATORY INFORMATION

ZONING: RESIDENTIAL CONSISTENT W/COMPREHENSIVE PLAN: YES APPLICABLE DEVELOPMENT REGULATIONS: REDMOND MUNICIPAL CODE & ZONING CODE COMPREHENSIVE PLAN DESIGNATION: SINGLE-FAMILY URBAN

IMPORTANT DATES

APPLICATION & COMPLETENESS DATE: JUNE 29, 2016

PUBLIC HEARING DATE & TIME: SEPTEMBER 26, 2016 (7:00) PM OR AS SOON THEREAFTER AS POSSIBLE

PLACE: CITY COUNCIL CHAMBERS, CITY HALL 15670 NE 85TH STREET, REDMOND WA 98073

BY: HEARING EXAMINER, SHARON RICE, THE OFFICES OF SHARON RICE HEARING EXAMINER, PLLC

DATE OF NOTICE: SEPTEMBER 5, 2016

PUBLIC COMMENT PERIOD: ALL INTERESTED PERSONS WHO WOULD LIKE TO BECOME A PARTY OF RECORD ARE INVITED TO TESTIFY AT THE PUBLIC HEARING TO EXPRESS THEIR VIEWS, OR SUBMIT WRITTEN TESTIMONY AT THE HEARING. ADDITIONALLY, YOU MAY BECOME A PARTY OF RECORD BY SUBMITTING WRITTEN COMMENTS (EMAIL IS ACCEPTABLE, PLEASE INCLUDE MAILING ADDRESS TO BECOME A PARTY OF RECORD) TO THE DEVELOPMENT SERVICES CENTER, LOCATED AT CITY HALL AT 15670 NE 85TH STREET, P.O. BOX 97010, MAIL STOP 2SPL, REDMOND, WA 98073-9710, OR FAX TO 425-556-2400. WRITTEN COMMENTS MUST BE SUBMITTED PRIOR TO THE HEARING AND BE RECEIVED NO LATER THAN **SEPTEMBER 26, 2016, BY 5PM.** ONLY PARTIES OF RECORD WILL HAVE THE RIGHT TO REQUEST RECONSIDERATION OF THE HEARING EXAMINER'S RECOMMENDATION AND/OR APPEAL THE DECISION TO CITY COUNCIL.

INFORMATION AVAILABLE: A COPY OF THE STAFF REPORT WILL BE AVAILABLE 21 DAYS PRIOR TO THE HEARING (COPIES CAN BE PROVIDED AT THE REQUESTOR'S COST), AND WILL BE POSTED ONLINE AT WWW.REDMOND.GOV/GOVERNMENT/HEARINGEXAMINER. THE APPLICATION AND ALL DOCUMENTS FILED BY THE APPLICANT ARE AVAILABLE FOR INSPECTION OR COPYING (AT THE COST OF THE REQUESTOR) AND ARE ON FILE IN THE DEVELOPMENT SERVICES CENTER. THE FILE MAY BE EXAMINED AT THE DEVELOPMENT SERVICES CENTER DURING BUSINESS HOURS.

PUBLIC HEARING INFORMATION AVAILABLE: FOLLOWING THE HEARING TO BE HELD ON **SEPTEMBER 26, 2016**, A COPY OF THE RECOMMENDATION WILL BE SENT TO PARTIES OF RECORD, AND CAN BE OBTAINED BY CONTACTING THE OFFICE OF THE HEARING EXAMINER, CITY OF REDMOND, MS: 3NFN, P.O. BOX 97010, REDMOND, WA 98073-9710. PHONE: 425-556-2191; OR AVAILABLE AT WWW.REDMOND.GOV/GOVERNMENT/HEARINGEXAMINER. THE APPEAL PROCEDURES WILL BE SET FORTH IN THE HEARING EXAMINER'S REPORT ISSUED IN THIS MATTER. IF YOU ARE HEARING OR VISUALLY IMPAIRED, NOTIFY THE OFFICE OF THE HEARING EXAMINER AT 425-556-2191 ONE WEEK IN ADVANCE OF THE HEARING IN ORDER TO BE PROVIDED ASSISTANCE.

CITY CONTACT INFORMATION:

PROJECT PLANNER NAME: SARAH VANAGS-PYLE

PHONE NUMBER: 425-556-2426

EMAIL: SVANAGS@REDMOND.GOV

VICINITY MAP

Hawks Glen, LAND-2015-01452

Parcel Number: 2526059067

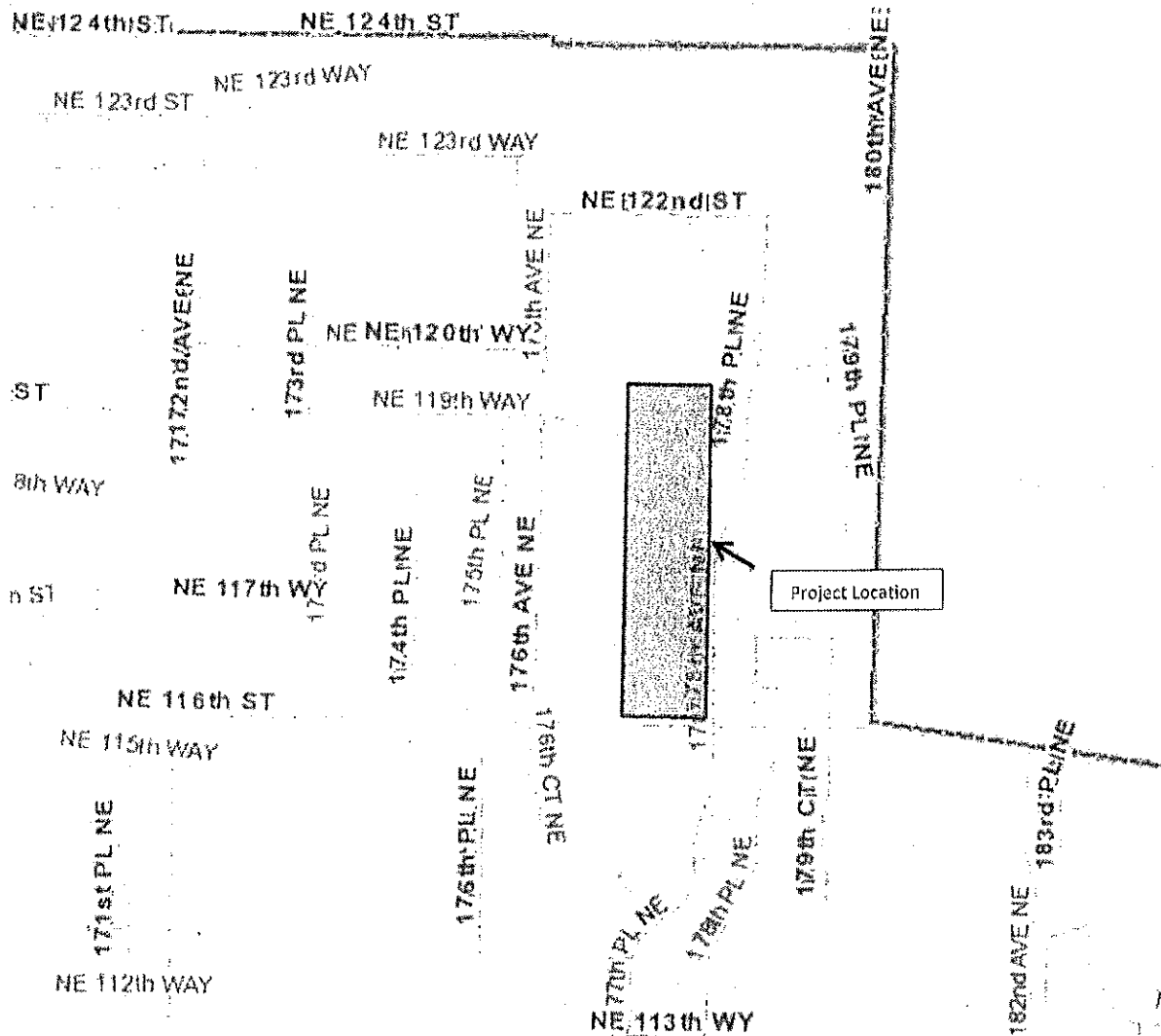
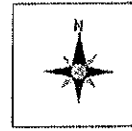



Certification of Public Notice

FILE: HAWKS GLENN – PPL LAND-2015-01452

CERTIFICATE OF MAILING

A **Notice of a Public Hearing** to be held on SEPTEMBER 26, 2016, was sent to the Applicant, Parties of Record, and property owners whose name and addresses appear on the attached list that has been provided to the Office of the Hearing Examiner by the City of Redmond Development Services Center by first class mail, on or before SEPTEMBER 5, 2016.

CERTIFICATE OF NEWSPAPER PUBLICATION

On AUGUST 31, 2016, a copy of the attached Notice of Public Hearing was sent to the Seattle Times (the City's official newspaper) to be published on SEPTEMBER 5, 2016.

CERTIFICATE OF POSTING AND PUBLIC NOTICE (Public Places)

On SEPTEMBER 5, 2016, a copy of the attached **Notice of Public Hearing** was posted at:
 Redmond City Hall: X Redmond Regional Library: X

I hereby certify under penalty of perjury under the laws of the State of Washington that the foregoing is true and correct.

Signed: My. Hart

Title: City Clerk

Date: 8/31/2016

Place: City of Redmond

CERTIFICATE OF POSTING AND PUBLIC NOTICE (On-Site)

On _____ I posted a copy of the attached **Notice of Public Hearing** on or near the site.

I, the undersigned, declare that Public Notice was given as required in the Redmond Zoning Code, 21.76.080(D) and certify under penalty of perjury under the laws of the State of Washington that the foregoing is true and correct.

Signed: _____

Title: _____

Date: _____

Place: _____

(City, State)

2015-01452SV
ABOUSHARKH ISMAIL A
11886 176TH AVE NE
REDMOND, WA 98052

2015-01452SV
AGRAWAL NITIN+ANSHU
17527 NE 120TH WAY
REDMOND, WA 98052

2015-01452SV
ANUMALLA SRIKANTH
17805 NE 120TH WAY
REDMOND, WA 98052

2015-01452SV
BADRINARAYANAN SRINIVASAN
11470 176TH CT NE
REDMOND, WA 98052

2015-01452SV
BANDLA PREETAM+PRATHIMA
11825 179TH PL NE
REDMOND, WA 98052

2015-01452SV
BJAJ SHARAD+KHANNA AARTI
11923 178TH PL NE
REDMOND, WA 98052

2015-01452SV
CESARIO MÂRCIO A G+FLAVIA
11925 179TH PL NE
REDMOND, WA 98052

2015-01452SV
CHEN HUNG-SHIUN+SHANG
12031 179TH PL NE
REDMOND, WA 98052

2015-01452SV
CHEN YING TING
11687 179TH PL NE
REDMOND, WA 98052

2015-01452SV
CHOKSHI BHAUMIK MAYANKBHAI
11452 178TH AVE NE
REDMOND, WA 98052

2015-01452SV
ACTOR MARY+ RYAN
12012 176TH AV NE
REDMOND, WA 98052

2015-01452SV
ANIKEEVA SVETLANA
11565 179TH CT NE
REDMOND, WA 98052

2015-01452SV
AYDIN CENGIZ+ALENA
1150 176TH CT NE
REDMOND, WA 98052

2015-01452SV
BAGGIO SUSANNA
2445 279TH DR SE
SAMMAMISH, WA 98075

2015-01452SV
BHANDARI NITIN+KOMAL KASHIR
12035 179TH PL NE
REDMOND, WA 98052

2015-01452SV
BURKETTE MICHAEL E+ROSE M
11666 175TH PL NE
REDMOND, WA 98052

2015-01452SV
CHANDRASEKARAN ASHOK
17809 NE 120TH WAY
REDMOND, WA 98052

2015-01452SV
CHEN JUNPU+LU ZHANG
12105 178TH PL NE
REDMOND, WA 98052

2015-01452SV
CHENG LONG+YIJIA CHEN
11881 178TH PL NE
REDMOND, WA 98052

2015-01452SV
COELHO ALEXANDRE A+LARISSA
17672 NE 119TH CT
REDMOND, WA 98052

2015-01452SV
AGGARWAL ASHISH+AGRAWAL
11910 178TH PL NE
REDMOND, WA 98052

2015-01452SV
ANTOUN TONY+RASIULYTE RASA
11892 178TH PL NE
REDMOND, WA 98052

2015-01452SV
AZIMI-GARAKANI NAVID
17668 NE 119TH CT
REDMOND, WA 98052

2015-01452SV
BALAKRISHNAN GANESH
11893 178TH PL NE
REDMOND, WA 98052

2015-01452SV
BIBB DAVID L+GWENDOLYN R
17817 NE 115TH WAY
REDMOND, WA 98052

2015-01452SV
CARLSON JENNIFER
11815 179TH PL NE
REDMOND, WA 98052

2015-01452SV
CHECK MARTIN P+NEETA
11474 176TH CT NE
REDMOND, WA 98052

2015-01452SV
CHEN WAYNE T+SU HYUN
11790 178TH PL NE
REDMOND, WA 98052

2015-01452SV
CHERRY CREEK ESTATE
11878 178TH PL NE
REDMOND, WA 98052

2015-01452SV
COLLEY FRED T III+JENNIFER
11568 178TH PL NE
REDMOND, WA 98052

2015-01452SV
CORDELL RICHARD+BO
17656 NE 119TH CT
REDMOND, WA 98052

2015-01452SV
Current Resident
17656 NE 116TH ST
REDMOND, WA 98052

2015-01452SV
Current Resident
17830 NE 117TH CT
REDMOND, WA 98052

2015-01452SV
Current Resident
17829 NE 117TH CT
REDMOND, WA 98052

2015-01452SV
Current Resident
17801 NE 117TH CT
REDMOND, WA 98052

2015-01452SV
Current Resident
12145 179TH PL NE
REDMOND, WA 98052

2015-01452SV
Current Resident
12016 176TH AVE NE
REDMOND, WA 98052

2015-01452SV
Current Resident
12010 176TH AVE NE
REDMOND, WA 98052

2015-01452SV
Current Resident
17811 NE 117TH CT
REDMOND, WA 98052

2015-01452SV
DALAL VIHANG+POORVA ARANKAL
17514 NE 119TH WAY
REDMOND, WA 98052

2015-01452SV
CURAN JOHN*P
11738 175TH PL NE
REDMOND, WA 98052

2015-01452SV
Current Resident
11864 178TH AVE NE
REDMOND, WA 98052

2015-01452SV
Current Resident
17821 NE 117TH CT
REDMOND, WA 98052

2015-01452SV
Current Resident
17817 NE 117TH CT
REDMOND, WA 98052

2015-01452SV
Current Resident
11790 178TH AVE NE
REDMOND, WA 98052

2015-01452SV
Current Resident
12033 179TH PL NE
REDMOND, WA 98052

2015-01452SV
Current Resident
12014 176TH AVE NE
REDMOND, WA 98052

2015-01452SV
Current Resident
17664 NE 119TH CT
REDMOND, WA 98052

2015-01452SV
Current Resident
11880 176TH AVE NE
REDMOND, WA 98052

2015-01452SV
DARBHA SATISH+SWATHI R
12020 176TH AV NE
REDMOND, WA 98052

2015-01452SV
Current Resident
11500 176TH CT NE
REDMOND, WA 98052

2015-01452SV
Current Resident
11671 179TH PL NE
REDMOND, WA 98052

2015-01452SV
Current Resident
17825 NE 117TH CT
REDMOND, WA 98052

2015-01452SV
Current Resident
17807 NE 117TH CT
REDMOND, WA 98052

2015-01452SV
Current Resident
11872 178TH PL NE
REDMOND, WA 98052

2015-01452SV
Current Resident
17674 NE 121ST CT
REDMOND, WA 98052

2015-01452SV
Current Resident
12012 176TH AVE NE
REDMOND, WA 98052

2015-01452SV
Current Resident
11553 179TH CT NE
REDMOND, WA 98052

2015-01452SV
Current Resident
11848 176TH AVE NE
REDMOND, WA 98052

2015-01452SV
DEO NIRANJAN+VIDYA JOSHI
11458 178TH AVE NE
REDMOND, WA 98052

2015-01452SV
DHAKAL RAMJI+ARATI DAHAL
17822 NE 115TH WAY
REDMOND, WA 98052

2015-01452SV
DUNLAP JANETTE L
11928 179TH PL NE
REDMOND, WA 98052

2015-01452SV
FISCHER VILLAGE HOA
16541 REDMOND WAY PMB 381-C
REDMOND, WA 98052

2015-01452SV
GERBER KASSIDY C+SANTANIELL
11501 176TH CT NE
REDMOND, WA 98052

2015-01452SV
GOODSELL STEVEN J+CHANG
12039 179TH PL NE
REDMOND, WA 98052

2015-01452SV
GUPTA AJAY+LOVEL G
11930 179TH PL NE
REDMOND, WA 98052

2015-01452SV
HAZELWOOD HOA
8040 161ST AVE NE #423
REDMOND, WA 98052

2015-01452SV
HORIZON CUSTOM HOMES LLC
PO BOX 1267
RENTON, WA 98057

2015-01452SV
INBAR EYAL+LIANIT
12123 177TH CT NE
REDMOND, WA 98052

2015-01452SV
JAYAPALAN RAJ+KABALEESWARAN
12109 178TH PL NE
REDMOND, WA 98052

2015-01452SV
DOSHI ANURAGKUMAR K+GUDDI
11921 179TH PL NE
REDMOND, WA 98052

2015-01452SV
EWING ERIC JF+REDMAN BRUCE
17508 NE 119TH WAY
REDMOND, WA 98052

2015-01452SV
FISCHER VIOLA K
11864 178TH PL NE
REDMOND, WA 98052

2015-01452SV
GHATE PRADIP SHRIRANG+SUSHA
17677 NE 121ST CT
REDMOND, WA 98052

2015-01452SV
GRIFFIN CANDACE
PO BOX 317
REDMOND, WA 98052

2015-01452SV
GUPTA ANUPAM+SANGEETA
11752 176TH AVE NE
REDMOND, WA 98052

2015-01452SV
HERNANDEZ SARA C OROPEZA
17808 NE 115TH WAY
REDMOND, WA 98052

2015-01452SV
HUANG CHANG+YAN SHEN
12022 178TH PL NE
REDMOND, WA 98052

2015-01452SV
IYER VENKATRAMAN BALASUBRAM
12101 178TH PL NE
REDMOND, WA 98052

2015-01452SV
JIA RUIBIN+TONG LIN
5442 119TH AVE SE
BELLEVUE, WA 98006

2015-01452SV
DOUGHERTY FRANCIS X+MARIANN
12016 176TH AV NE
REDMOND, WA 98052

2015-01452SV
FARAHDEL HASSAN+FROUZESH
12026 178TH PL NE
REDMOND, WA 98052

2015-01452SV
FUNG BRAHMNES T F
11884 175TH PL NE
REDMOND, WA 98052

2015-01452SV
GOLI NAVEEN+VEENADHARI
17664-A NE 119TH CT
REDMOND, WA 98052

2015-01452SV
GUO CHENLEI+MA JIEMING
11922 178TH PL NE
REDMOND, WA 98052

2015-01452SV
HAMDAN OSAMA A+KIFAH A
17671 NE 119TH CT
REDMOND, WA 98052

2015-01452SV
HERRING LUIS CARLOS VARGAS
12028 179TH PL NE
REDMOND, WA 98052

2015-01452SV
HUANG CHI JANG+WANG WAN JIU
11437 179TH CT NE
REDMOND, WA 98052

2015-01452SV
JAMBOTKAR GAUTAM D+KAMAT KS
11760 176TH AVE NE
REDMOND, WA 98052

2015-01452SV
JOSHI ANJALI
11445 179TH CT NE
REDMOND, WA 98052



2015-01452SV
JOSHI SACHIN JAYANT+RESHMA
17898 NE 117TH CT
REDMOND, WA 98052

2015-01452SV
KANADE ABHIJAT+KESHKAMAT
17667 NE 121ST CT
REDMOND, WA 98052

2015-01452SV
KEATING JONAS+CHRISTINE
11931 179TH PL NE
REDMOND, WA 98052

2015-01452SV
KIM SEUNG G+KYOUNG Y
12023 178TH PL NE
REDMOND, WA 98052

2015-01452SV
KUMAR KIRAN+BINA VISWANATH
17680 NE 121ST CT
REDMOND, WA 98052

2015-01452SV
LARSON ANDER K+SUTAROVA EVA
11768 176TH AVE NE
REDMOND, WA 98052

2015-01452SV
LI LU HUA+FUHWEI LWO
17525 NE 120TH WAY
REDMOND, WA 98052

2015-01452SV
LIU XUNYI
16541 REDMOND WAY #496C
REDMOND, WA 98052

2015-01452SV
MA YAN+WEI SHI
12034 179TH PL NE
REDMOND, WA 98052

2015-01452SV
MEHTA MAYANK+NIKITA BABEL
11610 176TH AVE NE
REDMOND, WA 98052

2015-01452SV
KAKULAMARRI LAXMI N+BOYANPA
17665 NE 119TH CT
REDMOND, WA 98053

2015-01452SV
KAPNER CHARLES
12104 178TH PL NE
REDMOND, WA 98052

2015-01452SV
KHAN MUZZAMMIL+KHADIJA
12020 178TH PL NE
REDMOND, WA 98052

2015-01452SV
KING COUNTY-PROPERTY SVCS
500 4TH AVE
SEATTLE, WA 98004

2015-01452SV
KUMAR KSHAMA S+SUIJT S
11898 178TH PL NE
REDMOND, WA 98052

2015-01452SV
LEVY EAL+MEIRAV FANI
12119 177TH CT NE
REDMOND, WA 98052

2015-01452SV
LIN CHAO-CHUNG+YI-FEN CHOU
11866 175TH PL NE
REDMOND, WA 98052

2015-01452SV
LLIESCU VALENTIN+ALINA MARI
11564 178TH PL NE
REDMOND, WA 98052

2015-01452SV
MADHUSOODANAN JULIE+SRINIVA
12014 176TH AV NE
REDMOND, WA 98052

2015-01452SV
MOHAMED ABDULWAJID+SHAHINA
11758 175TH PL NE
REDMOND, WA 98052

2015-01452SV
KALIL WYLE+DAOUDIEH NISREEN
11914 178TH PL NE
REDMOND, WA 98052

2015-01452SV
KARIMI FARAJ+MARYAM
17653 NE 119TH CT
REDMOND, WA 98052

2015-01452SV
KHERA TARUN+APEKSHA GODIYAL
11572 178TH PL NE
REDMOND, WA 98052

2015-01452SV
KRISHNA VIJAY+PREETI
17529 NE 120TH WAY
REDMOND, WA 98052

2015-01452SV
KUZNETSOVA EKATERINA
17756 NE 114TH CT
REDMOND, WA 98052

2015-01452SV
LEWORTY MICHAEL+CROSS BELIN
17681 NE 121ST CT
REDMOND, WA 98052

2015-01452SV
LIU HUIMIN+FALLAH-MOGHADDAM
17662 NE 121ST CT
REDMOND, WA 98052

2015-01452SV
LO JUSTIN C
11750 175TH PL NE
REDMOND, WA 98052

2015-01452SV
MARCELAIS MICHAEL+LIN
11505 176TH CT NE
REDMOND, WA 98052

2015-01452SV
MOVVA RAMU+MADHUSRI
17691 NE 122ND ST
REDMOND, WA 98052



2015-01452SV
MURRAY WILLIAM R
11712 176TH AVE NE
REDMOND, WA 98052

2015-01452SV
NARAYANAN MURALI+MYTHILI
11918 178TH PL NE
REDMOND, WA 98052

2015-01452SV
NELSON KIMBERLY
17685 NE 121ST CT
REDMOND, WA 98052

2015-01452SV
OSTERGREN BRIAN H+WAN QIAOL
11449 178TH AVE NE
REDMOND, WA 98052

2015-01452SV
PENKOV IVAN S+DARINA D DECH
15606 NE 40TH ST #L246
REDMOND, WA 98052

2015-01452SV
PONNUSAMY KRUTHIKA+SETHURAM
11455 178TH PL NE
REDMOND, WA 98052

2015-01452SV
PRINCE LUTHER W+SUSAN K
17518 NE 119TH WAY
REDMOND, WA 98052

2015-01452SV
RAJURS DINESH+MADHURI
17673 NE 121ST CT
REDMOND, WA 98052

2015-01452SV
RAMMANOHAR ARUMUGAM+KALYANI
11874 175TH PL NE
REDMOND, WA 98052

2015-01452SV
RAY MEADOWS LLC
22106 76TH AVE W #B
EDMONDS, WA 98026

2015-01452SV
MUTHUSAMY RANGARAJAN+PALANI
11569 179TH CT NE
REDMOND, WA 98052

2015-01452SV
NATH YOGESH+DHRITI DIXIT,
11581 179TH CT NE
REDMOND, WA 98052

2015-01452SV
NGUYEN RAYMOND H+TOT B
12114 177TH CT NE
REDMOND, WA 98052

2015-01452SV
PANDEY LOKESH+MOHITA KAUSHI
11576 178TH PL NE
REDMOND, WA 98052

2015-01452SV
PEREZ JUAN J+KRYSTAL L D
17801 NE 120TH WAY
REDMOND, WA 98052

2015-01452SV
PRABHU VASUDEV+SANGEETA MAR
11663 179TH PL NE
REDMOND, WA 98052

2015-01452SV
PURUSHOTHAMAN SHANMUGA
11584 178TH PL NE
REDMOND, WA 98052

2015-01452SV
RAMAMOORTHY GANESH+ANITA IY
11655 179TH PL NE
REDMOND, WA 98052

2015-01452SV
RANJAN PIYUSH+SUKANYA
11580 178TH PL NE
REDMOND, WA 98052

2015-01452SV
ROBERTS SCOTT A+STEPHANIE R
11887 178TH PL NE
REDMOND, WA 98052

2015-01452SV
NAIR RAJEET+NIDHI CHAUDHARI
11915 178TH PL NE
REDMOND, WA 98052

2015-01452SV
NAVIN JOY+NISHI NAVIN
11929 179TH PL NE
REDMOND, WA 98052

2015-01452SV
NI HONG
11956 176TH AVE NE
REDMOND, WA 98052

2015-01452SV
PASALA SURESH CHOWDARY+DEEP
11441 179TH CT NE
REDMOND, WA 98052

2015-01452SV
PERUMAL PALANI+JAYABARATHY
11823 179TH PL NE
REDMOND, WA 98052

2015-01452SV
PRAVAT DANIEL+CLAUDIA
11547 179TH CT NE
REDMOND, WA 98052

2015-01452SV
QIN BAI LIN+YUPING LIU
12025 178TH PL NE
REDMOND, WA 98052

2015-01452SV
RAMAN SANTHOSH+VEDHASHREE R
11515 176TH CT NE
REDMOND, WA 98052

2015-01452SV
RATHI JAY RAMCHANDRA+BHAVNA
11819 179TH PL NE
REDMOND, WA 98052

2015-01452SV
ROUSSEL COREY MICHAEL+LAURE
11509 176TH CT NE
REDMOND, WA 98052

2015-01452SV
S&I PROPERTIES LLC
23609 56TH AVE W
MOUNTLAKE TERRACE, WA 98043

2015-01452SV
SHIEH JON-YIE+KO HUEI-LING
16426 NE 40TH ST
REDMOND, WA 98052

2015-01452SV
SKINNER-GRAY JULIAN+JENNIFE
11478 176TH CT NE
REDMOND, WA 98052

2015-01452SV
SONI ASHISH+MENKA
11878 175TH PL NE
REDMOND, WA 98052

2015-01452SV
STOVER RICHARD+NEVIL TYSON
11679 179TH PL NE
REDMOND, WA 98057

2015-01452SV
SYRELL STEVEN+SVENJA GUDALL
17750 NE 114TH CT
REDMOND, WA 98052

2015-01452SV
TILLEY DENNIS L+DANIELLE R
11746 175TH PL NE
REDMOND, WA 98052

2015-01452SV
UJJWAL SINHA
11742 175TH PL NE
REDMOND, WA 98052

2015-01452SV
VENATI JAGADISH+BASKARAN
11919 178TH PL NE
REDMOND, WA 98052

2015-01452SV
WARD ROBERT & MICHELLE
11811 179TH PL NE
REDMOND, WA 98052

2015-01452SV
SAUCERMAN DUANE B+KARA
11821 179TH PL NE
REDMOND, WA 98058

2015-01452SV
SHIM NATHAN+EUN JI CHO
11862 175TH PL NE
REDMOND, WA 98052

2015-01452SV
SOBHANI DOLLY+MAL DIBYENDU
11508 176TH CT NE
REDMOND, WA 98052

2015-01452SV
SPENCER MONICA L
17657 NE 119TH CT
REDMOND, WA 98053

2015-01452SV
STOWE DEAN
17663 NE 121ST CT
REDMOND, WA 98052

2015-01452SV
TEO PENG HENG+KIT BING TAM
12032 179TH PL NE
REDMOND, WA 98052

2015-01452SV
TUFFAHA NASEEM+LENA KHALAF
12019 178TH PL NE
REDMOND, WA 98052

2015-01452SV
VALLENE BRIAN E+MICHELLE M
17661 NE 119TH CT
REDMOND, WA 98053

2015-01452SV
VENKATASUBRAMANIAN KISHORE
11917 179TH PL NE
REDMOND, WA 98052

2015-01452SV
WEBSTER JAMES R+DAWN M
12115 177TH CT NE
REDMOND, WA 98052

2015-01452SV
SEKARAN DHIGHA+PANDIAN AGNI
11886 178TH PL NE
REDMOND, WA 98052

2015-01452SV
SINGH MANINDER+THIND RAMAN
11456 178TH PL NE
REDMOND, WA 98052

2015-01452SV
SOMANATHAN MUTHUVEER+SUJATH
11560 178TH PL NE
REDMOND, WA 98052

2015-01452SV
SRINIVASAN LAKSHMINARAYANA+
11511 176TH CT NE
REDMOND, WA 98052

2015-01452SV
SURESH SHIVALINGALAH+MAMATH
11927 178TH PL NE
REDMOND, WA 98052

2015-01452SV
THAKKAR PULIN
11662 175TH PL NE
REDMOND, WA 98052

2015-01452SV
TUNG LE-WU+TSAI SHU-CHEN
17660 NE 119TH CT
REDMOND, WA 98052

2015-01452SV
VANDEVOORT BRADLEY+CAROLYN
12024 178TH PL NE
REDMOND, WA 98052

2015-01452SV
WANG YU
17890 NE 117TH CT
REDMOND, WA 98052

2015-01452SV
WHISTLER'S RIDGE HOA
PO BOX 2347
REDMOND, WA 98073

2015-01452SV
XIE JIAWEI+LIYI ZHU
17814 NE 115TH WAY
REDMOND, WA 98052

2015-01452SV
YALAMANCHILI MALIK+BOBBA
17670 NE 121ST CT
REDMOND, WA 98053

2015-01452SV
XIE SIYANG+SIWEN SUN
17652 NE 119TH CT
REDMOND, WA 98052

2015-01452SV
YU HAIFENG+MINYI HUANG
11870 178TH PL NE
REDMOND, WA 98052

2015-01452SV
XU SHILIYANG+FAN ZHOUYING
11868 176TH AVE NE
REDMOND, WA 98052



Chuck Dalger
14150 NE 20th St Ste f-1 #392
Bellevue, WA 98007

Sujit Kumar
11898 178tyh^opl NE
Redmond, WA 98052

Brian Vallene
17661 NE 119th Ct
Redmond, WA 98052

Chris Curtin
2304 138th Ave SE
Bellevue, WA 98005

Ryan & Cassandra McKinney
11848 - 176th Ave NE
Redmond, WA 98052

PARTIES OF RECORD
Hawk's Glen LAND-2015-01452